

# RUBBAIR DOOR

## flat-door model

Specifications: Non-insulated, flexible

Order Number: \_\_\_\_\_

Date: \_\_\_\_/\_\_\_\_/\_\_\_\_

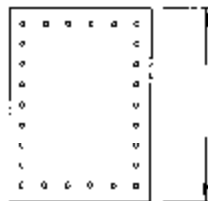
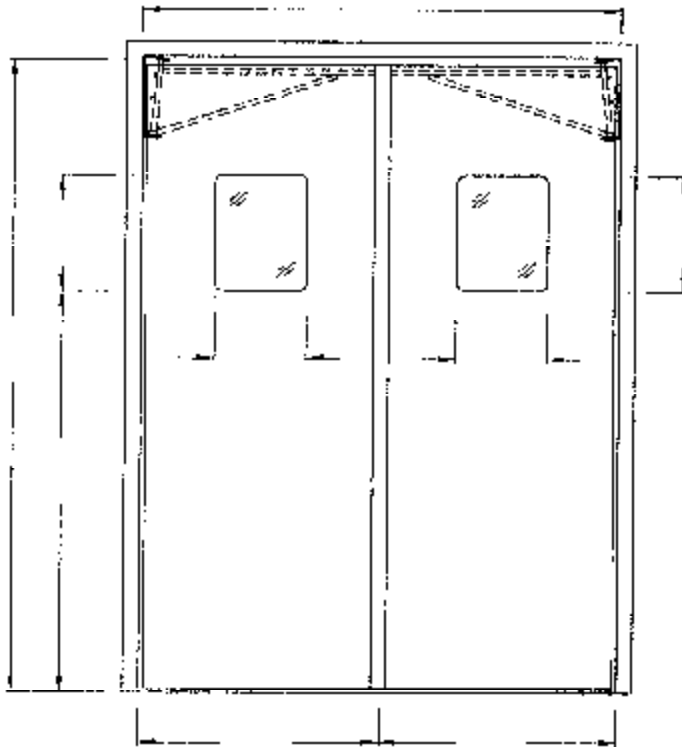

Impact Panels

Sold To: \_\_\_\_\_

PO #: \_\_\_\_\_

Job Name: \_\_\_\_\_

Ship Week of: \_\_\_\_/\_\_\_\_/\_\_\_\_

Quantity: \_\_\_\_\_ Pair / Single

Net Opening: \_\_\_\_\_" Wide \_\_\_\_\_" High

Cafe Undercut \_\_\_\_\_" Overcut \_\_\_\_\_

### DOOR FEATURES & OPTIONS

**DOOR MODEL**

Model 150, 1/4" PVC Vinyl is standard  
 Colors: Gray Black Blue Bro  
 Beige Red Green

Model 180, 2 Layers of 40 oz Vinyl Fabric  
 Colors: Black Blue Brown Belg  
 Red Green

**ABS IMPACT PANELS**

No Impact Panels is standard

12" High

24" High

36" High

48" High

**WINDOW SIZES**

18" x 15" is standard

Full Width Vision

**SEALS**

No Perimeter Air Seal is standard

Top and Bottom Wipers

Jamb Edge Balloon Gaskets

**INSTALLATION ACCESSORIES**

Aluminum Frame  
 Build rough opening 1 1/4" wider and 5/8" taller than doors to accommodate frames

2" x 6" Tubular Steel Frame, KD  
 Build rough opening 4 1/2" wider and 2 1" taller than doors to accommodate frames

**JAMB CONSTRUCTION**

E Z Hang hinge requires a minimum double 2x4 wood jamb.

**SPECIAL OPTIONS / NOTES**

\_\_\_\_\_  
 \_\_\_\_\_  
 \_\_\_\_\_

**APPROXIMATE WEIGHT**

2.75 lbs. per sq. ft. X \_\_\_\_\_ sq. ft. = \_\_\_\_\_ lbs.

Approved: \_\_\_\_\_ Date: \_\_\_\_\_